

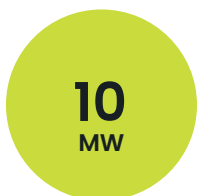

TOKYO WEST 1 BUILDING 1

The Tokyo West 1, Building 1 (TKW1-1) is the first data center in a multi-phase campus consisting of three-3 story buildings and an on-site substation with 50 MVA power secured by TEPCO. Designed for sustainability, Building 1 is approximately 2,500 sm with 2 data halls that can support up to 10 MW of IT load and is scheduled to be customer ready in early 2025.



TOTAL IT LOAD



CUSTOMER READY



DATA HALLS

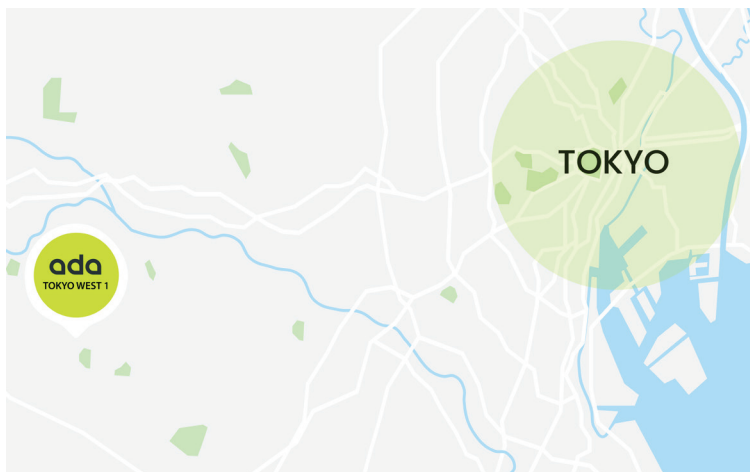

Coordinates | 35.61363, 139.40391

Location

- » Tama City, Tokyo
- » 34km from Tokyo Central Business District
- » 1h15m from Tokyo Station (by train)
- » 1h20m from Haneda Airport (by car)

Power & Reliability

- » Designed 1.4 PUE
- » N+1 UPS redundancy
- » Gas turbine generator
- » 100% clean energy enabled

Cooling & Efficiency

- » Closed loop air cooled chiller plant to fan coil walls serving each data hall
- » WUE: 0 (no evaporative heat rejection)
- » N+1 configuration
- » Buffer tanks for chilled water system

Connectivity

- » Carrier Neutral with 2 diverse zero vaults and 3 POEs per building

Fire Protection

- » Fire alarm system for entire building
- » Dual interlock pre-action fire suppression system

Security & Compliance

- » 24/7/365 onsite security personnel with anti-climb fencing perimeter & monitored by electronic and video surveillance.
- » Multifactor access controls with biometrics.



TOKYO WEST 1 DATA CENTER CAMPUS

The Tokyo West 1 is a 31 MW, 3 building data center campus totaling approximately 40,100 square meters. Designed for sustainability, the campus is situated within close proximity to other major hyperscale data centers and carriers offering a network rich connectivity environment.

TKW1-1

- » Under construction
- » 10 MW IT Load
- » Customer ready in 2025

TKW1-2

- » Under construction as of May 2024
- » 10 MW IT Load
- » Customer ready in 2027
- » High-density AI hardware capable

TKW1-3

- » 11 MW IT Load
- » High-density AI hardware capable

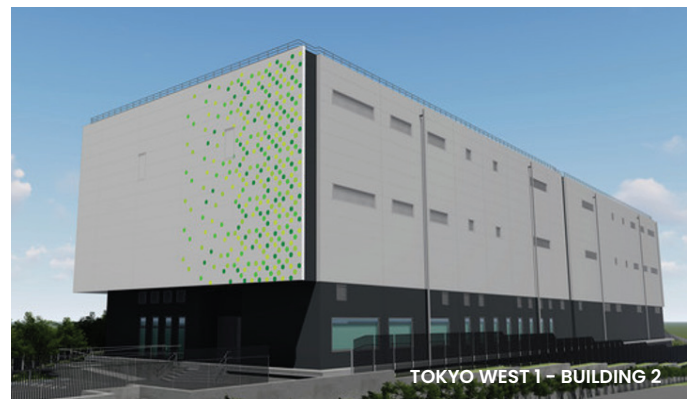

TOKYO MARKET OVERVIEW

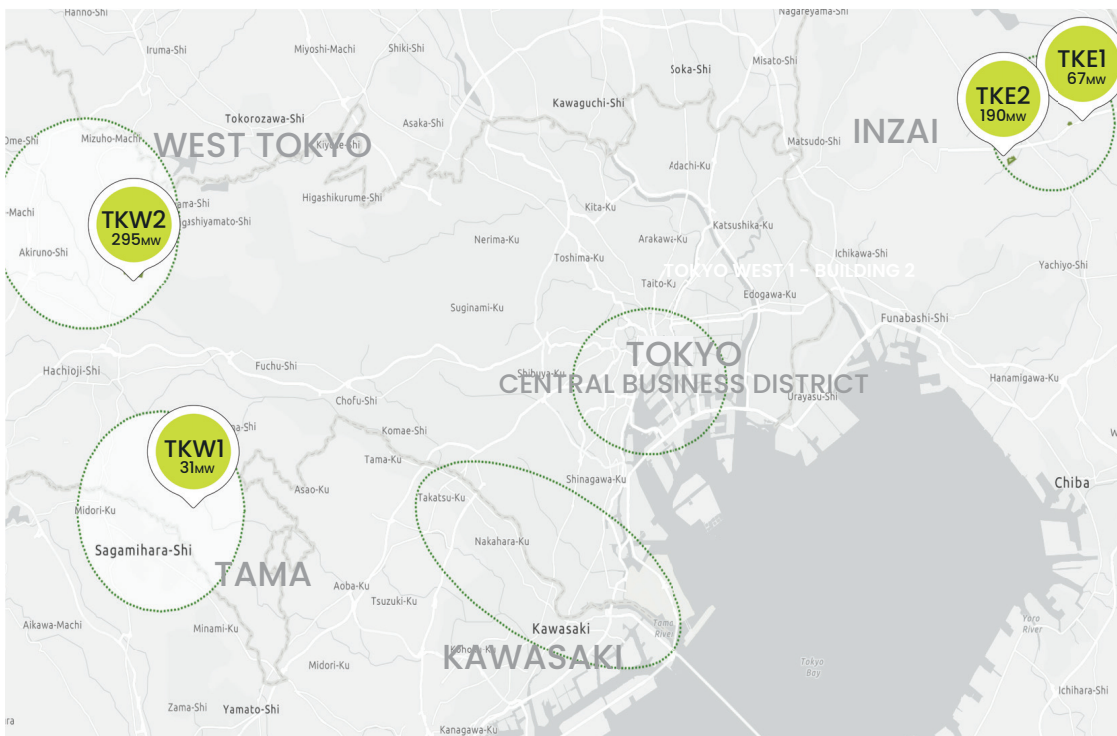

JAPAN DATA CENTER CAPACITY*

600 MW
TOTAL IT LOAD

900 MVA
POWER COMMITMENT

5
CAMPUSES

*Includes 18 MW in Osaka

**Lead the world in
sustainable digital
infrastructure that
benefits technology,
people, and the planet.**



ABOUT ADA INFRASTRUCTURE

Ada Infrastructure is a global data centre business committed to being a positive force for technology, people, and the planet. With a world-class team of trusted industry leaders combined with the capital-raising, investment and asset management expertise of GCP, Ada Infrastructure is positioned to lead the industry in reliable, safe, secure, and sustainable digital infrastructure. With seven in-flight campuses across Japan, the UK, and Brazil, we have over 1 GW of power currently available and more than 1,500 MW in our global pipeline.

Let's Talk:

info@adainfrastructure.com
16F Yaesu Central Tower, Tokyo Midtown Yaesu,
2-2-1 Yaesu, Chuo-ku, Tokyo
104-0028 Japan

www.adainfrastructure.com
www.adainfrastructure.com/ja-JP



日本語



ENGLISH

